

COPYRIGHT

THIS DRAWING AND DESIGN IS THE PROPERTY OF BEL-CON DESIGN-BUILDERS AND SHALL NOT BE REPRODUCED, ALTERED, DISTRIBUTED, OR COPIED IN WHOLE OR IN PART WITHOUT THE EXPRESSED WRITTEN CONSENT OF BEL-CON DESIGN-BUILDERS

SITE STATISTICS

DESCRIPTION	PROVIDED	PERCENT %
TOTAL LOT AREA	12984.9 m ²	100.0 %
EXISTING BUILDING AREA	982 m ²	8
PROPOSED ADDITION AREA	557 m ²	4
LANDSCAPED AREA	7765.9 m ²	60
ASPHALT AREA	3680 m ²	28
	PROVIDED	REQUIRED
# OF EXISTING PARKING SPACES	62	65
# OF NEW PARKING SPACES	28	23
# OF NEW B.F. SPACES	4	4
# OF COMPANY VEHICLE SPACES	0	0
TOTAL # OF PARKING SPACES	94	92
# LOADING SPACES	1	1
	PROVIDED	REQUIRED
ZONE: EMP2		
FRONT YARD DEPTH	19.8 m	15.0 m
REAR YARD DEPTH	76.5 m	12.0 m
EXTERIOR SIDE YARD WIDTH (NORTH)	18 m	15.0 m
INTERIOR SIDE YARD WIDTH (SOUTH)	29.4 m	3.0 m
LOT COVERAGE	N/A	N/A
BUILDING HEIGHT	7.3 m	< 12.0 m

LEGEND

	PARKING SPACE NUMBER
	BARRIER FREE PARKING
	POINTS OF EGRESS
	LOT LINE / PROPERTY LINE
	REQUIRED SETBACK LINE
	TRAFFIC FLOW
	EXISTING TREE

OP DESIGNATION: SERVICE EMPLOYMENT

ZONING: SERVICE EMPLOYMENT

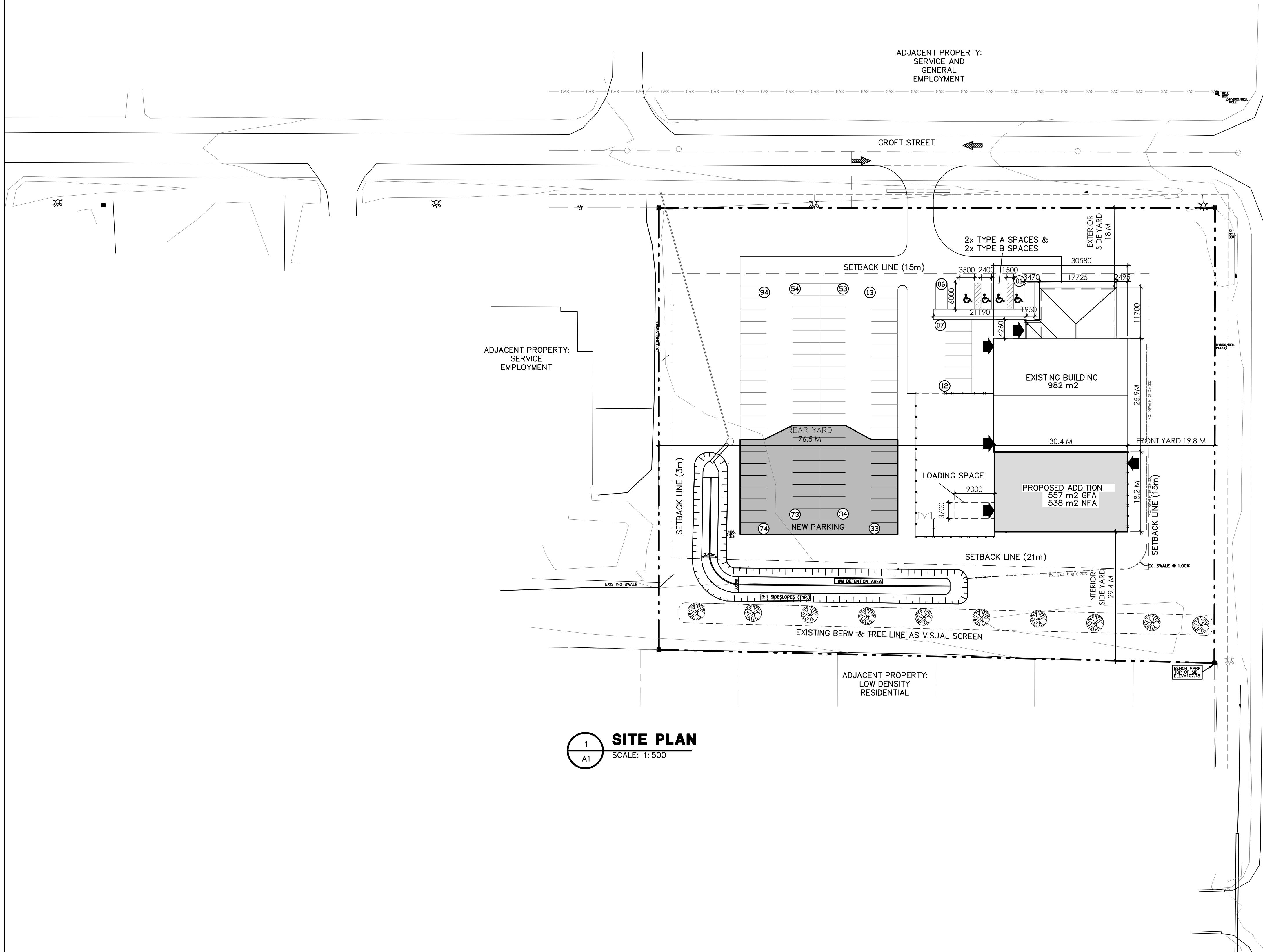

1 SITE PLAN
SCALE: 1:500

NO.	DATE	REVISIONS	BY
01	09.19.24	ISSUED TO ADDRESS PRE-CONSULT COMMENTS	BDN

BEL-CON
DESIGN-BUILDERS LTD

TELEPHONE: (613) 968-6707 1-335 UNIVERSITY AVE
WWW.BEL-CON.COM BELLEVILLE, ONTARIO

NEW ADDITION FOR:
UBJCA CARPENTERS UNION
459 CROFT STREET
PORT HOPE, ONTARIO

SITE PLAN		DATE:	CONTRACT No.:
CHECKED BY:	BDN	06/18/2024	2429
DESIGNED BY:	WA		
DRAWN BY:	WA		
SCALE:	1:500		

A1